



AZS RAMMING MASS

Physical and chemical index

Item	AZSM-06J ERSOL 06
Chemical Composition	Al ₂ O ₃ 48
	ZrO ₂ 30
	SiO ₂ 20
	Others 2
Bulk density g/cm ³	3.1
Crystallographic analysis after being sintered at 1300/1500°C	Corundum, zirconium oxide
Thermal conductivity	Good
Anti-corrosion property	Excellent at 1300°C
particle diameter of grain	0-0.6mm
Application temperature	Cold/low temperature
Quantity of water	10-12% (proportion by weight)
Solidification	Water (ceramic)
Packaging	25kg/bag
Quality guarantee period	12 months



ZHENGZHOU SUNRISE REFRACTORY CO., LTD

Used for	Under bottom paving, spreading and the place between fused cast brick and ERSOL 50
----------	---

- USAGE:**
1. Open the bag to check if the coagulant agent is dampened or hardened, and then spread the coagulant agent uniformly into the bag;
 2. Mix certain amount of the mass according to on-site assumption. When it mixes well, add room temperature water by a ratio of 6-7%, or adjust the ratio according to local climatic condition and water content of the mixture. Blend it till there is no raw ramming mass left or till that it will break into pieces instantly when it falls to the ground after one unlooses his grip of the mass from the height of 0.33 meters;
 3. The construction site and bonder should be clean and without sundries. The leftover well-mixed mass should be covered with plastic sheet film or placed in shady and cool place. The mass that is not dry and hard can be used again; otherwise, it should be crushed and used together with other raw material or abandoned.
 4. Mix with water to make the material like slurry then press smooth by vibrating.

CONCRETING TIME: BEGINNING TIME: 0:15~2:00 HOURS

FINISHING TIME: 3:00~6:00 HOURS

HEATING TIME: AFTER 150:00 HOURS

THIS MATERIAL IS WITHOUT PHOSPHORUS,
AND DOES NOT POLLUTE THE ENVIROMENT.

The Melting End

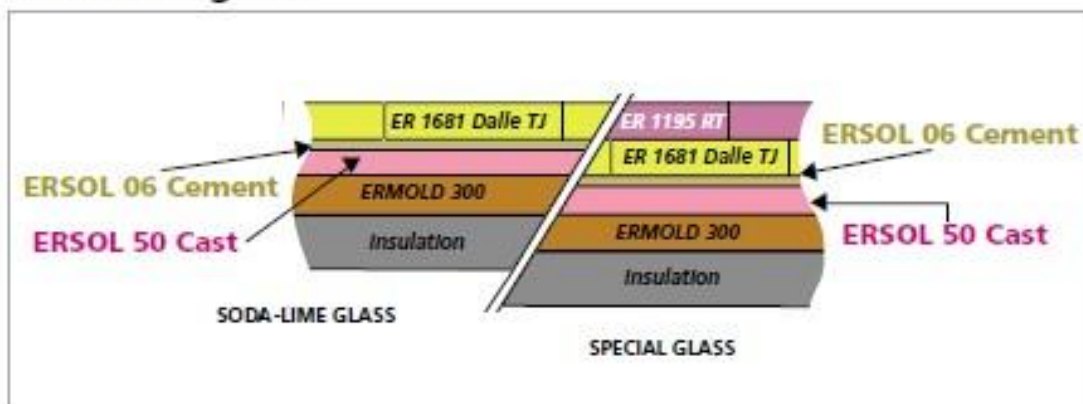

Target Wall

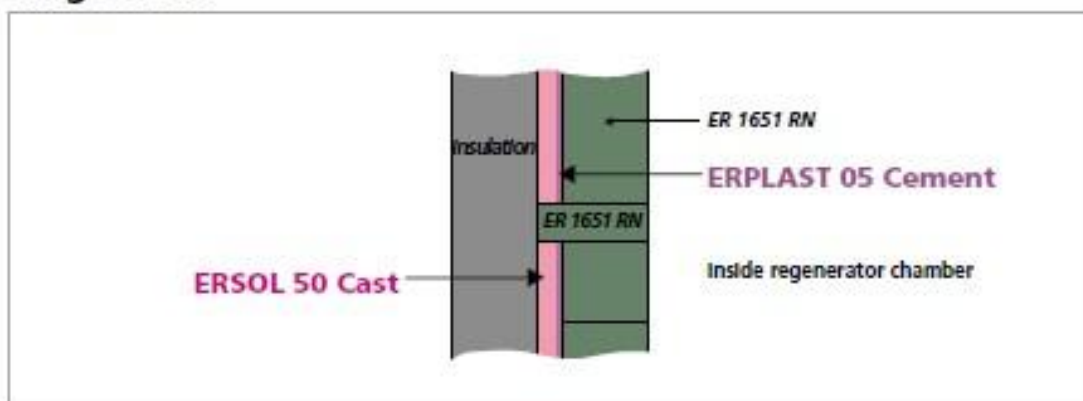

Safety layer for Feeder Channel

